

- NOTES**
- ROUGH GRADING AND CONSTRUCTION STAKING ARE TO BE PROVIDED BY THE TOWN OF AKRON.
 - UTILITY LOCATIONS SHOWN ARE APPROXIMATE. IT IS THE CONTRACTOR'S RESPONSIBILITY TO HAVE THE UTILITIES IN THE AREA OF THE PROJECT LOCATED BEFORE CONSTRUCTION BEGINS.
 - ALL PERMITS AND LICENSES NECESSARY FOR THE PROJECT SHALL BE THE RESPONSIBILITY OF THE CONTRACTOR AND PAID FOR BY THE CONTRACTOR.
 - THE CONTRACTOR SHALL REMOVE ALL EXCESS DIRT, WASTE MATERIALS AND TRASH FROM THE SITE.
 - ANY LAND MONUMENTS DESTROYED OR MOVED BY THE CONTRACTOR SHALL BE RESET BY A REGISTERED COLORADO LAND SURVEYOR AT THE CONTRACTOR'S EXPENSE.
 - THE PROGRESSION OF WORK SHALL BE SUCH THAT VEHICULAR ACCESS TO RESIDENCES IS ALWAYS MAINTAINED.

- SS — EXISTING SEWER LINE
- W — EXISTING WATERLINE
- T — TELEPHONE LOCATE
- X — EXISTING FENCE LINE
- OHE — OVERHEAD ELECTRIC LINE
- PP POWER POLE
- DOWN GUY
- α FH FIRE HYDRANT
- ▣ CONCRETE

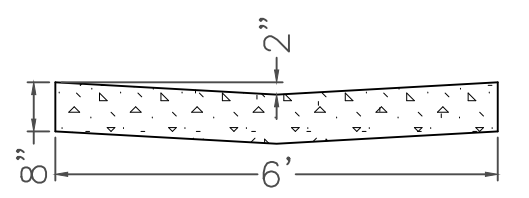

SCALE: 1" = 40'
U.S. SURVEY FEET

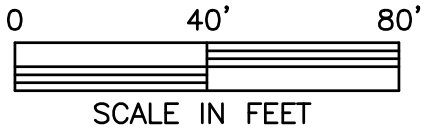

6' CONCRETE PAN DETAIL

CDOT CLASS B CONCRETE (3000 PSI MIN.)
CONCRETE SHALL BE FIBER REINFORCED.
MAXIMUM SPACING OF CONTRACTION JOINTS - TEN (10) FEET.
CONCRETE SURFACE TO RECEIVE A LIGHT BROOM FINISH.

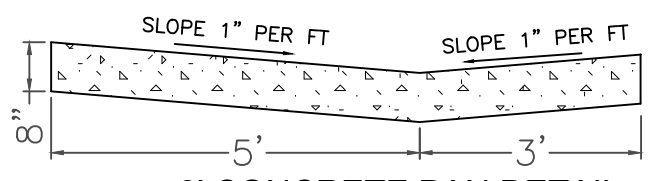

8' CONCRETE PAN DETAIL

CDOT CLASS B CONCRETE (3000 PSI MIN.)
CONCRETE SHALL BE FIBER REINFORCED.
MAXIMUM SPACING OF CONTRACTION JOINTS - TEN (10) FEET.
CONCRETE SURFACE TO RECEIVE A LIGHT BROOM FINISH.

DATE: 10/26/20
 PROJECT: T-40
 SHEET: 01

GLOSSON DEVELOPMENT SERVICES, LLC
 565 98H AVENUE
 AKRON, CO 80720
 (970) 371-6678

ADAMS AVENUE ROADWAY
 AKRON, CO

(Empty box)

DRAWN FOR:
TOWN OF AKRON
 245 MAIN AVENUE
 AKRON, CO 80720